

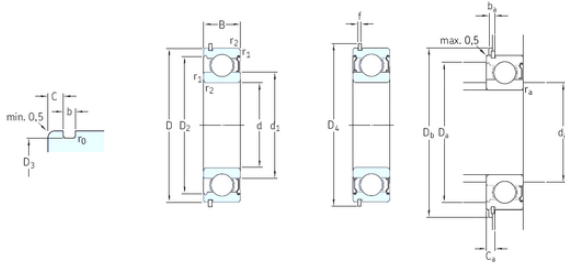

SKF BEARING MANUFACTURING CO.,LTD.



50 mm x 110 mm x 27 mm SKF 6310-ZNR deep groove ball bearings

Bearing No. 6310-ZNR

6310-ZNR Bearing 2D drawings and 3D CAD models

Size	50x110x27 mm
Bore Diameter	50 mm
Outer Diameter	110 mm
Width	27 mm
d	50 mm
D	110 mm
B	27 mm
C	27 mm
b	2,7 mm
d1	68,7 mm
f	2,46 mm
r0 max.	0,6 mm
r1 min.	2 mm
r2 min.	2 mm
C	3,28 mm
D2	95,2 mm
D3	106,81 mm
D4	116,6 mm
ba min.	5,74 mm
Ca max.	5,74 mm
da min.	3 mm
da max	68,7 mm
Da max.	99 mm
Db min.	118 mm
ra max.	2 mm



SKF BEARING MANUFACTURING CO.,LTD.

Weight	1,1 Kg
Basic dynamic load rating (C)	65 kN
Basic static load rating (C0)	38 kN
Fatigue load limit (Pu)	1,6
Reference speed	13000 r/min
Limiting speed	8500 r/min
Calculation factor (f0)	13
Category	Single Row Ball Bearings
Inventory	0.0
Manufacturer Name	SKF
Minimum Buy Quantity	N/A
Weight / Kilogram	1.121
EAN	7316577739124
Product Group	B00308
Enclosure	1 Metal Shield
Precision Class	ABEC 1 ISO P0
Maximum Capacity / Filling Slot	No
Rolling Element	Ball Bearing
Snap Ring	Yes
Internal Special Features	No
Cage Material	Steel
Internal Clearance	C0-Medium
Inch - Metric	Metric
Long Description	50MM Bore; 110MM Outside Diameter; 27MM Outer Race Width; 1 Metal Shield; Ball Bearing; ABEC 1 ISO P0; No Filling Slot; Yes Snap Ring; No Internal Special Features; C0-Medium Internal Clearance; Ste
Other Features	Deep Groove With Snap Ring



SKF BEARING MANUFACTURING CO.,LTD.

Category	Single Row Ball Bearing
UNSPSC	31171504
Harmonized Tariff Code	8482.10.50.68
Noun	Bearing
Keyword String	Ball
Manufacturer URL	http://www.skf.com
Manufacturer Item Number	6310-ZNR
Weight / LBS	2.3856
Outside Diameter	4.331 Inch 110 Millimeter
Inner Race Width	0 Inch 0 Millimeter
Outer Race Width	1.063 Inch 27 Millimeter
Bore	1.969 Inch 50 Millimeter
d_1	68.76 mm
D_2	95.2 mm
D_3	106.81 mm
D_4	116.6 mm
r_0 max.	0.6 mm
$r_{1,2}$ min.	2 mm
d_a min.	61 mm
d_a max.	68.7 mm
D_a max.	99 mm
D_b min.	118 mm
b_a min.	3 mm
C_a max.	5.74 mm
r_a max.	2 mm
Basic dynamic load rating C	65 kN
Basic static load rating C_0	38 kN
Fatigue load limit P_u	1.6 kN
Calculation factor k_r	0.03
Calculation factor f_0	13
Mass bearing	1.11 kg
Snap ring	SP 110



SKF BEARING MANUFACTURING CO.,LTD.